

BLDG 15
Reese Technology Center
Lubbock, Texas 79416

FOR LEASE

Premises:

10,376 SF

Rental Rate: \$6/SF/MG

Availability: Now

Features:

- Former Library
- Office/Lab/Special Purpose
- Accommodate Multiple Uses
- Ample Parking

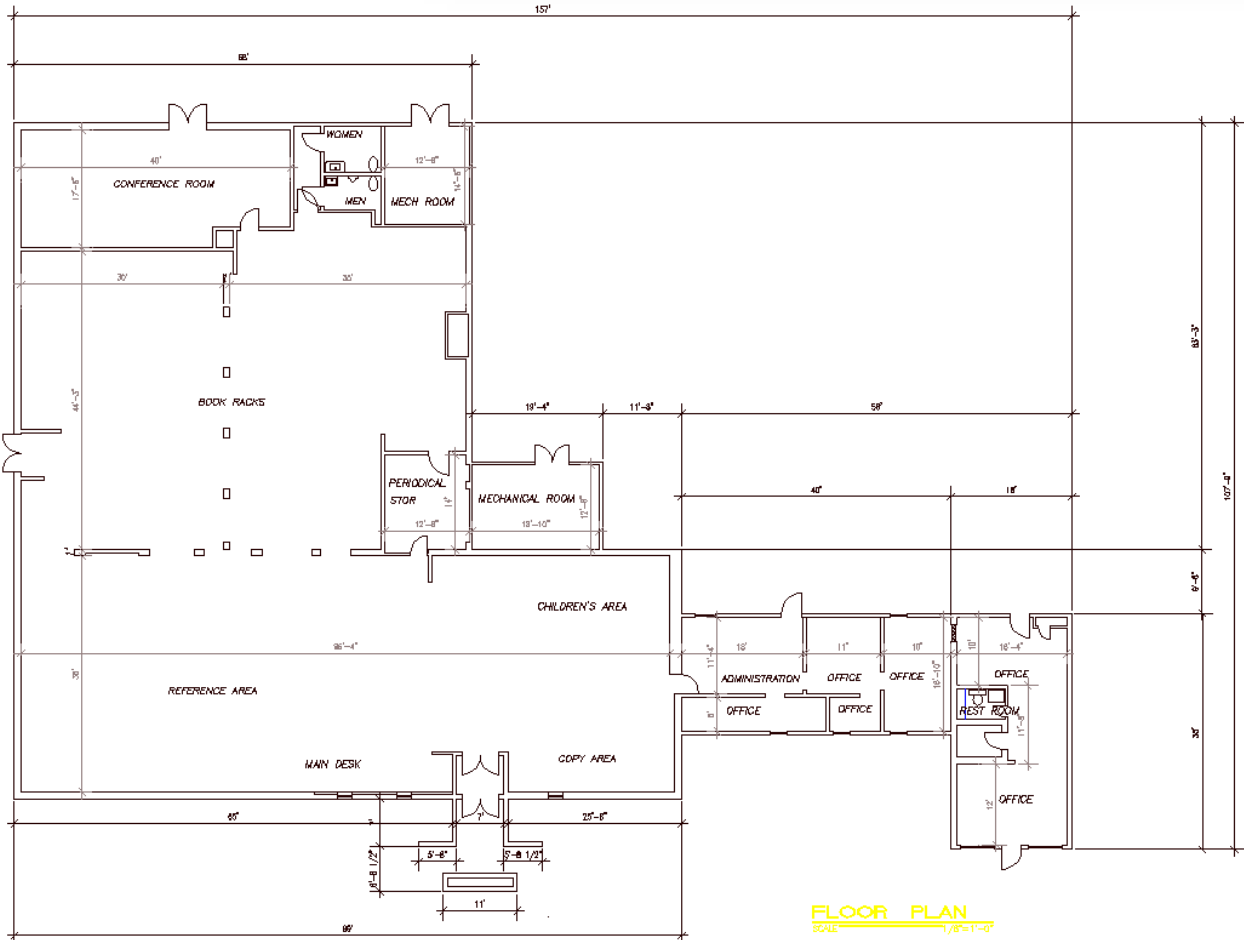

9801 Reese Blvd, Ste 200, Lubbock, TX 79416
 tel 806.885.6592 ■ www.reesecenter.com

Property Amenities

BUILDING:	15
ADDRESS:	902 Eisenhower Dr. Lubbock, TX 79416
LEASE RATE:	\$6 PSF per Year "AS IS"
LEASE TYPE:	Modified Gross
SECURITY DEPOSIT:	Equal to First Month's Rent
BUILDING TYPE:	Office / Lab / Showroom
ZONING:	Commercial
PARKING SPACES:	Ample
SQUARE FOOTAGE (APPROX):	10,376
YEAR BUILT:	1942
STORIES:	1
DIMENSIONS:	53 x 37
CONSTRUCTION TYPE:	Concrete foundation, Wood Floors and Walls
ROOF TYPE:	Asphalt Shingles
EXTERIOR TYPE:	Brick
FIBER:	Wireless Connection/ Fiber Nearby
ELECTRIC:	South Plains Electric Cooperative
POWER CAPACITY:	208 Volt 3 Phase
GAS:	Atmos Energy
WATER:	City of Lubbock
WATER LINE:	2" Line
SEWER:	City of Lubbock
SEWER LINE:	4" Line
NEAREST INTERSTATE:	Interstate 27
DISTANCE:	10 Miles
NEAREST HIGHWAY:	State Highway 114
DISTANCE:	1 Mile - Direct entrance to airfield
NEAREST RAIL:	Permian Basin Railway
DISTANCE:	1 Mile



9801 Reese Blvd, Ste 200, Lubbock, TX 79416
tel 806.885.6592 ■ www.reesecenter.com

Reese Technology Center

Technology ★ Research ★ Engineering ★ Education ★ Manufacturing